

Modifry's S2000 Windscreen Camera Mount

This product is designed specifically for the Honda S2000 equipped with the OEM rear windscreen (wind deflector). Do not use this mount on any other vehicle or without the factory windscreen, as the strength and stability of the mount is dependant on the wide clamping area of the windscreen base. Each time you use your windscreen mount be sure to check all mounting hardware and tighten if necessary.

Caution - Camera mounts that are improperly attached or overloaded can come lose and cause property damage or personal injury. While Modifry Products has designed these mounts with safety in mind we cannot control installation or mounting methods and are not responsible for loss of equipment, property damage, or injury caused by use of these products. Use of camera mounts is at your own risk!

Installation:

1. Carefully pry out the two plastic screw caps on the rear of the windscreen base and remove the Philips head screws. This may require holding the nuts on the under-side of the glove box lid with an 8mm socket. Photo 1
2. Remove the wind screen, then replace the nuts in their holes and temporarily tape over the nuts to hold them in place. Photo 2
3. You may want to put some duct tape on the bottom of the base plate to minimize chaffing that could mar the surface of the glove box lid. Photo 2
4. While holding the wind screen, position the base plate of the camera mount under the windscreen, line up the holes, and then insert the screws through the wind screen and camera mount base plate.
5. Place the windscreen/base plate back on the glove box lid making sure the screws fall into the holes. Photo 3.
6. You should be able to partially tighten the screws without raising the lid because the nuts are held in place by the tape. If you have trouble starting the screws it sometimes helps to turn the screw *backwards* a full turn to allow the threads to line up, then screw them forward to get them started.
7. Once the screws are started, lift the lid and tighten up the screws using a Philips screw driver and 8mm socket.
8. Put the plastic screw covers back in, and remove the tape from the bottom of the lid.

Mounting a camera:

1. Attach the pedestal to the base by tilting it back toward the windscreen and engaging the rear of the quick-release clip under the base, then press on the front edge of the pedestal to lock it in place. You should hear a distinct 'snap' as it locks in position. Be careful you don't hit the wind screen when attaching the pedestal. You may have to fold the windscreen down to attach the pedestal or if you have a large camera. Photo 4 and 5.
2. Turn the locking ring all the way down, tight against the swivel head.
3. Rotate the head of the mount (or your camera) to thread the 1/4-20 bolt into the bottom of your camera as far as it will easily go. For maximum holding power you want to thread use as much of the bolt as possible into the base of the camera, but do not exert enough force to damage the camera base.
4. Now firmly snug up the locking ring against the base of the camera. This is very important, as a loose locking ring can allow the camera to vibrate and unscrew itself off the pedestal head.
5. Loosen the thumb screw on the side of the pedestal just enough to allow the head to rotate and swivel, then aim the camera and tighten the thumb screw.
6. Give the camera and mount a firm shake to make sure nothing is loose.

Hints:

- In some cases it's easier to mount your camera to the pedestal before clipping the pedestal to the base plate.
- Once the camera is aimed you can remove the entire pedestal/camera for safe-keeping and replace it later without having to re-aim the camera.

This product is guaranteed against defects in materials or workmanship for a period of one year from date of purchase. If you experience any trouble with this camera mount please contact us (see below) for help or before returning any items. If you've lost a piece of the mount or require spare parts please contact us for information. Do not return products without prior authorization – credit will NOT be issued. All items are subject to a re-stocking charge of 20%.

Web site for more information: www.modifry.com
Email for questions of any kind: bob@modifry.com



Photo 1 – Remove screw caps and Philips screws, then lift off wind screen.



Photo 2 – Replace the nuts and tape them in place. Put tape on bottom of base plate to prevent chaffing.

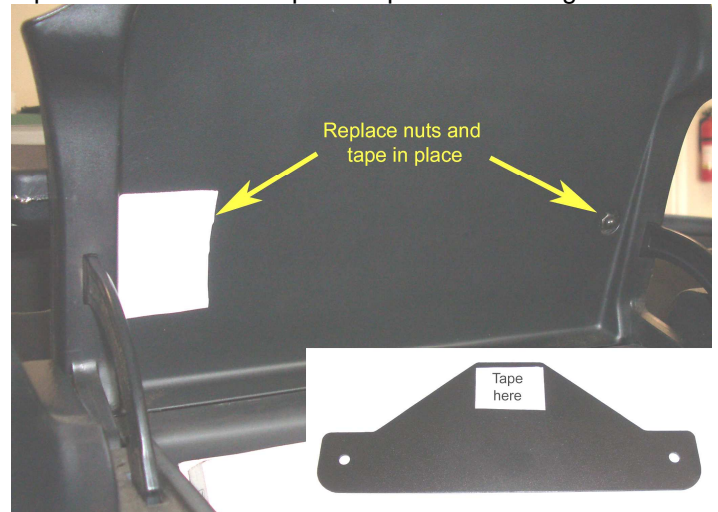

Photo 3 – Place wind screen and base back on glove box lid, feeding screws into holes. Tighten screws.



Photo 4 – Tilt pedestal back and catch rear edge under base plate.



Photo 5 – Press on front edge of pedestal to lock it into position. Lift lever to remove.



Photo 6 – Camera mounted

